



Whilst every effort is made to give a fair description, the accuracy of these particulars is not guaranteed, neither do they constitute an offer or contract.

MATHESONS ESTATE AGENTS have not tested any apparatus, equipment, fitting or services and so cannot verify that they are in working order. The buyer is advised to obtain verification from their solicitor or surveyor. Measurements are correct to within +/- 6 A sonic tape is used. None of the statements contained in these particulars or any of our properties are to be relied upon as a representation of fact.

166 Manor Park Road
Harlesden
London
NW10 4JT
T: 020 8965 2250
E: sales@mathesonsestates.com
www.mathesonsestates.com



St. Marys Road, London, NW10 4AN

Offers In The Region Of £399,995 Leasehold - Share of



KEY FEATURES:

- Two double bedroom Period apartment
- Large private garden
- Fitted Kitchen
- Share of freehold
- Ideal Investment
- Close to transport links
- Private entrance
- Must be seen
- Excellent condition
- Priced to sell

A bright and spacious two double bedroom period apartment with its own private entrance and large private garden. The property is offered for sale for the first time in many years and offers a rarely available opportunity to acquire a spacious ground floor flat in a sought after road and with brilliant transport links on your doorstep. Also with a share of freehold and in excellent condition throughout early viewing is considered essential and all serious offers around the guide price will be considered.

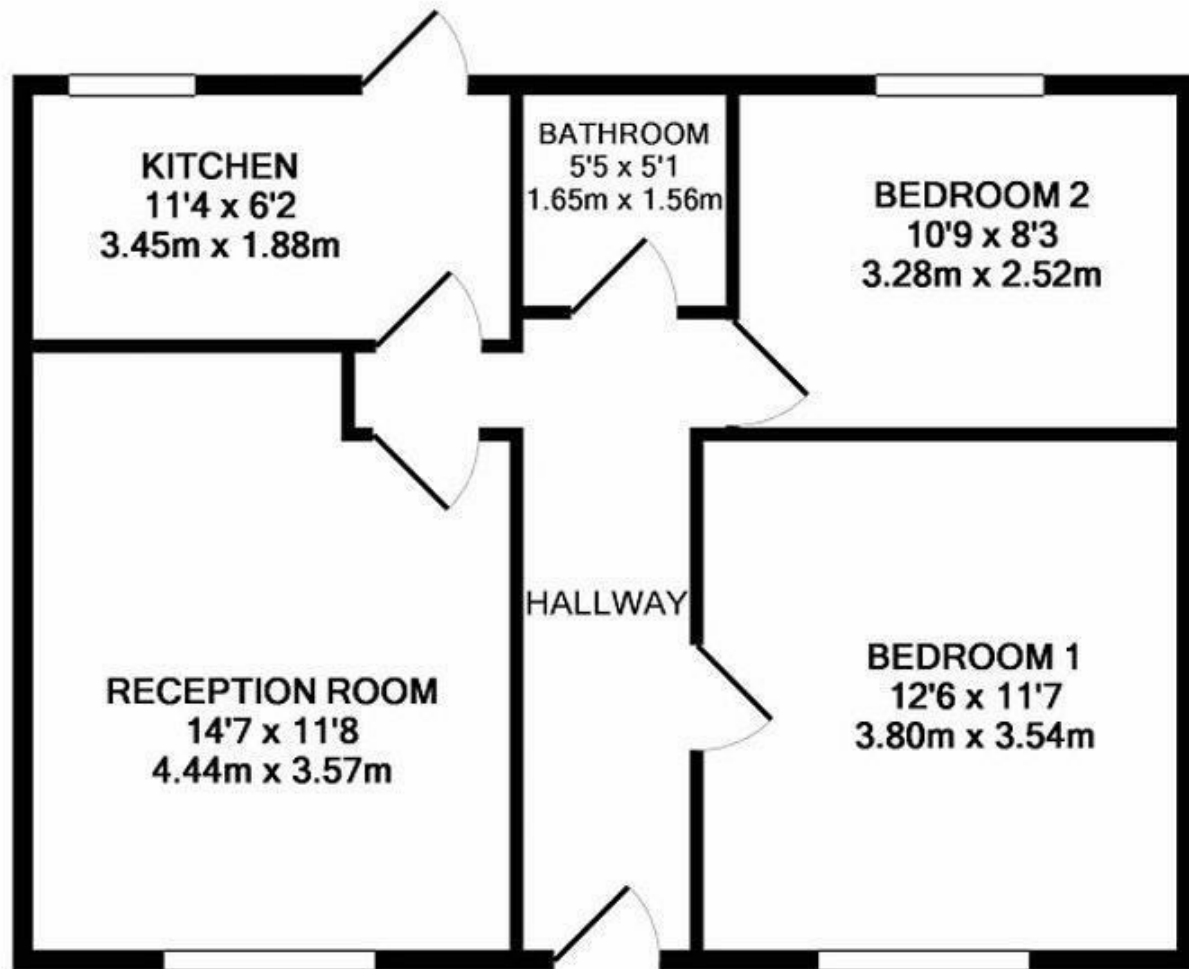

TOTAL APPROX. FLOOR AREA 572 SQ.FT. (53.2 SQ.M.)

